

Product change notification (PCN)

Title / short description	New plastic tool
Affected article category	Electronic housing
Change category	Form and appearance
Change number	PAC190023-03

Purpose/objective of the change

New plastic tool

Detailed description of the change

The previous plastic tool has reached the end of its service life and must be replaced by a new tool. As part of this, a product improvement will be introduced in the form of optimized radii. In addition, the text applied will change from "PA 66-FR" to "PA-FR" and a nest designation will be added. This does not affect the component's function.

Identifying characteristics

Batch increase for items

Start of Production (SOP)	-	Last Time Delivery (LTD)	-
Effective date (EOP)	2020-08-01	End of Service (EOSR)	-
End of Sales (EOS)	-		

Short-term change (< 6 months) or discontinuation (< 12 months), due to:

- | | | |
|---|---|--|
| <input type="checkbox"/> Software / Firmware Bugfix | <input type="checkbox"/> Short-term delivery stop by supplier | <input type="checkbox"/> Short-term recall by supplier |
| <input type="checkbox"/> Force majeure | <input type="checkbox"/> Product improvement with customer benefits | |
| <input checked="" type="checkbox"/> Others | | |

The previous plastic tool has reached the end of its service life; therefore, a replacement is required as soon as possible.

Attachments

- PCN190023-old.jpg
- PCN190023-new.jpg
- Material_list.csv
- PCN-PAC190023-03 Neues Kunststoffwerkzeug_DE
- PCN-PAC190023-03 New plastic tool_EN

Material list

Item	Article Type	Hardware / Firmware		Item	Substitute item Type
		old	new		
1175270	SET ME MAX BK USIS V2 VPE100	00	01		
2896610	ME MAX B-17,5 FRBK	01	02		
2915054	ME MAX B-22,5 FRBK	01	02		
2199692	ME MAX B-22,5 GYBN	01	02		
2201016	ME MAX B-17,5 KMGY BO	01	02		
2201267	ME MAX B-17,5 BK	01	02		
2279978	ME MAX B-22,5 RD	02	03		
2200736	ME MAX B-22,5 BUGY	01	02		
1027765	ME MAX 90 2-2 KMGY S1124	00	01		
2200636	ME MAX 22,5 FKDSO DEMO-SET	00	01		
2202821	ME MAX B-22,5 GYWH2	00	01		
2200581	UM 45-PROFIL 13,3CM	01	02		
2201586	ME MAX B-22,5 GY	01	02		
2202521	ME MAX B-22,5 YE 1004	01	02		
2707916	ME MAX B-22,5 GN	00	01		
1106852	ME MAX B-22,5 PGBU	01	02		
2203780	ME MAX 45 2-2 KMGY S1051	00	01		
2890166	ME MAX B-22,5 KMGY S75	00	01		
2199362	ME MAX 35 2-2 SET KMGY S6	01	02		
2915724	ME MAX 45 U-U1 KPL KMGY S87	00	01		
2901686	ME MAX B-22,5 GNTQ P+F	01	02		
2200471	ME MAX B-17,5 PGBU	02	03		
2707929	ME MAX B-22,5 KMGY	01	02		
2202385	ME MAX B-22,5 RD	01	02		
2890153	ME MAX B-17,5 BU	01	02		
2200587	ME MAX 45 2-2 KMGY SET S407	01	02		
2706991	ME MAX B-17,5 GN	01	02		
2202524	ME MAX 22,5 2-2 DEV-KIT KMGY	01	02		
2202216	ME MAX B-22,5 GY7016	01	02		
2201017	ME MAX B-22,5 KMGY BO	00	01		
2706959	ME MAX B-17,5 KMGY	01	02		
2869317	ME MAX B-22,5 BK	00	01		
2695882	ME MAX B-22,5 YE	01	02		
2200723	ME MAX B-22,5 KMGY VPE500	00	01		
2202303	ME MAX B-22,5 KMGY E+H	01	02		
2697136	ME MAX B-22,5 BU	01	02		
2278474	ME MAX B-17,5 GYWH	00	01		
5101849	SAMPLE-RAIL ME MAX GEH	00	01		

Item	Article Type	Hardware / Firmware		Item	Substitute item Type
		old	new		
5101849	SAMPLE-RAIL ME MAX GEH	01	02		
		01	02		
		03	04		

old

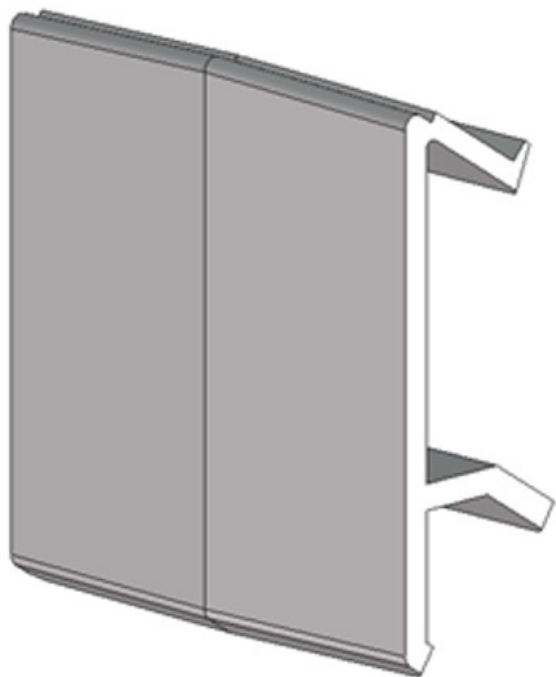

old

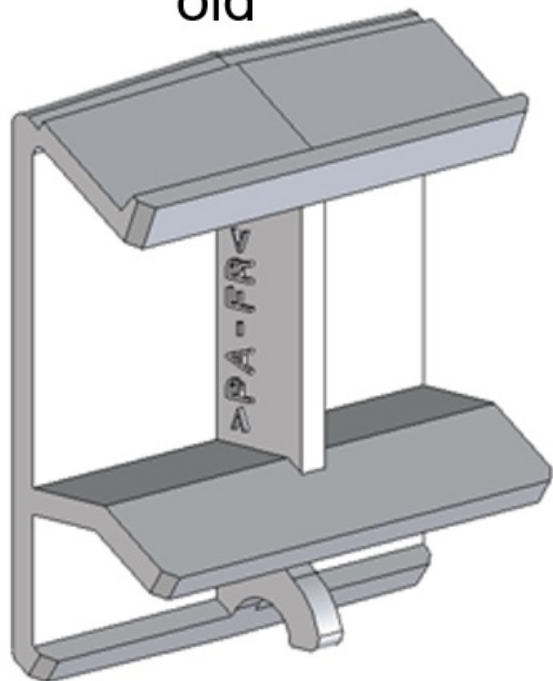

new

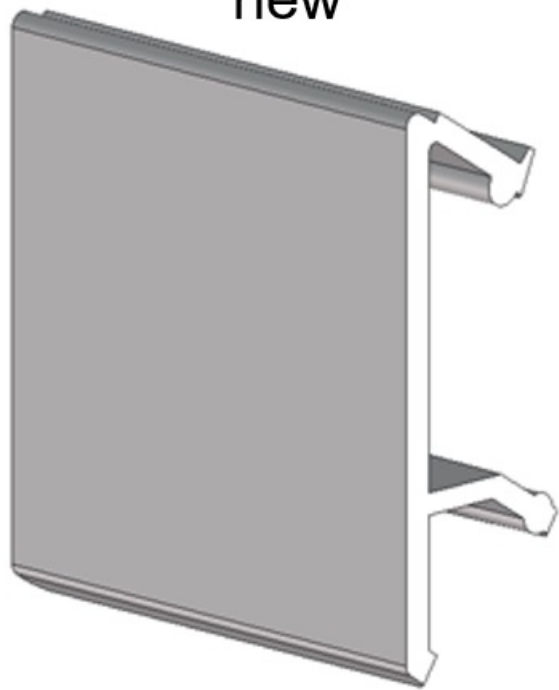

new

